



11 Templars Court, Nottingham, NG7 3GT

£1,250 Per Month

2 1 1 B

A set of four icons representing property features: a bed icon with the number '2', a bathtub icon with the number '1', a sofa icon with the number '1', and a menu icon with the letter 'B'.

Floor Plan

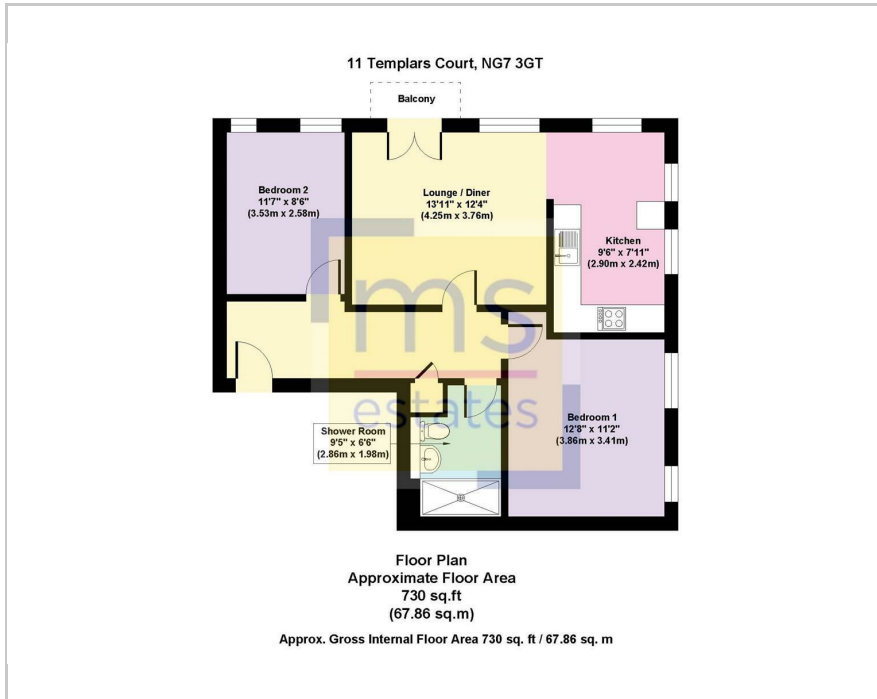

- Available from September
- Beautifully presented apartment
- 2 Double bedrooms
- Contemporary bathroom with large shower cubicle
- Spacious living area with TV
- Modern kitchen/dining area
- Balcony
- Allocated parking space for one car
- Close to local amenities



Area Map



Energy Efficiency Rating

	Current	Potential
Very energy efficient - lower running costs		
(92 plus) A		
(81-91) B		
(69-80) C		
(55-68) D		
(39-54) E		
(21-38) F		
(1-20) G		
Not energy efficient - higher running costs		
England & Wales	EU Directive 2002/91/EC	

These particulars, whilst believed to be accurate are set out as a general outline only for guidance and do not constitute any part of an offer or contract. Intending purchasers should not rely on them as statements of representation of fact, but must satisfy themselves by inspection or otherwise as to their accuracy. No person in this firm's employment has the authority to make or give any representation or warranty in respect of the property.

3 Park Street, Derby Road, Lenton, Nottingham, NG7 1RR

Tel: 0115 9120061 Email: mail@ms-estates.co.uk www.ms-estates.co.uk